



SPECIFICATION FOR APPROVAL

CUSTOMER:
MODEL NO: **ATB6010L-12TH2B-PD3**
DESCRIPTION: **12 Volt DC Blower**
DATE: **May 29, 2007**

CUSTOMER APPROVAL SIGNATURE

CUSTOMER APPROVED STAMP

*PLEASE RETURN ONE TO US AFTER CHECKING

UTECH

United Thermal Engineering Corporation

453 Ravendale Dr., Suite C

Mountain View, CA 94043

Tel : 650-428-1188

Fax : 650-428-1110

E-Mail : info@utecusa.com

Web Site : www.utecusa.com

PRODUCT SPECIFICATION

A. GENERAL SPECIFICATION

ITEM		SPECIFICATION/CONDITION
A-1	Part No.	ATB6010L-12TH2B-PD3
A-2	Outline Dimension	B60X60X10 (II)
A-3	Rated Voltage	12V
A-4	Operating Voltage Range	7~13.8V
A-5.1	Rated Current	0.21A
A-5.2	Actual Current	0.16A
A-6	Power Consumption	2.52W
A-7	Rated Speed	4500RPM±10%
A-8	Max. Airflow	5.22CFM
A-9	Max Static Pressure	11.66 mmH2O
A-10	Noise Level	33.6 dBA(Max:36.9 dBA)
A-11	Rotation Direction	Anti-clockwise Direction

B. ELECTRICAL SPECIFICATION

ITEM		SPECIFICATION/CONDITION
B-1	Temperature life expectancy	70000 Hours
B-2	Insulation Resistance	At least 10MΩ at 500VDC between housing and both lead wires.
B-3	Dielectric Strength	Withstand 600VAC 1 minute 1Ma between housing and both lead wires.

C. MAIN MATERIAL/PARTS SPECIFICATION

ITEM	MAJOR COMPONENTS	MATERIAL OR TYPE	GRADE
C-1	Housing & Impeller	Plastic	
C-2	Splash Proof	NO	
C-3	Weight	24.1g	
C-4	LEAD WIRES	UL1007/1095/2468#28 Parallel wire	
C-5	CONNECTOR HOUSING	NP Two lead wire	
C-6	CONNECTOR		
C-7	BEARING	Ball Bearing	

D. ENVIRONMENTAL SPECIFICATION

ITEM		SPECIFICATION/CONDITION
D-1	Operation Temperature	-10°C, ~+70°C, /66%(RH)°C
D-2	Storage Temperature	-40°C, ~+70°C, /66%(RH) °C

D-3 Environment Humidity Less than 85%(RH)

E-1. Shock test

Pulse shape: Half-sine wave

Shock duration time: 2ms

Velocity: 70~100 inch/sec

Number of shocks: One shock for each of six faces (Total: six shocks)

E-2. Vibration

Frequency range: 10~500Hz scan 15 minutes

Direction: X,Y,Z

Acceleration: 1.5g r.m.s. each direction 2 hours

Figure 1. Fan Performance Curve

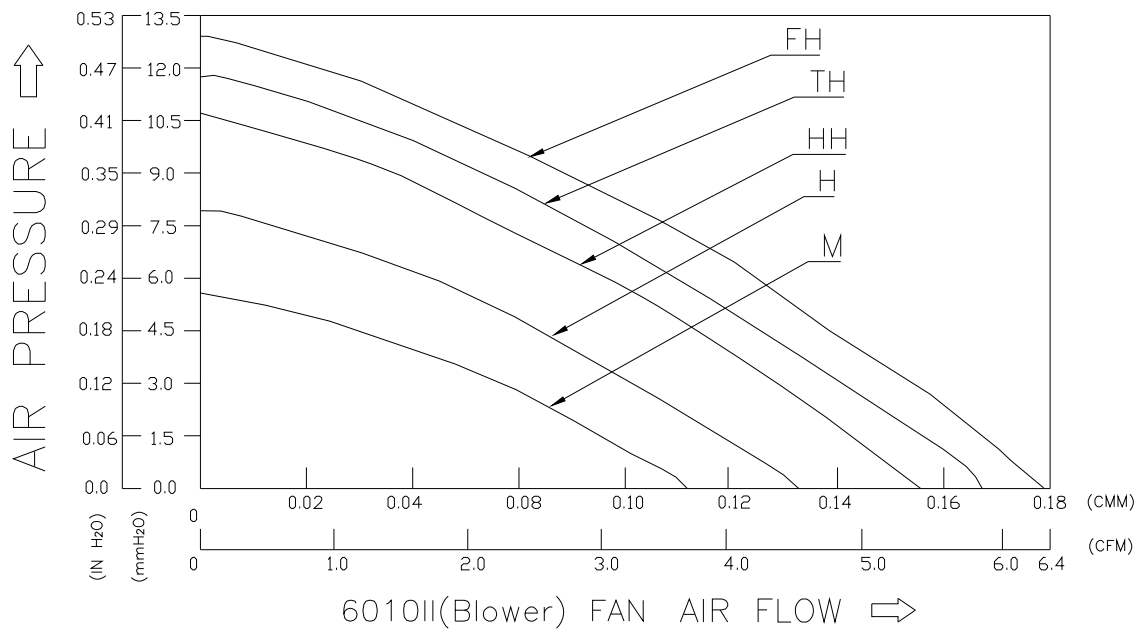
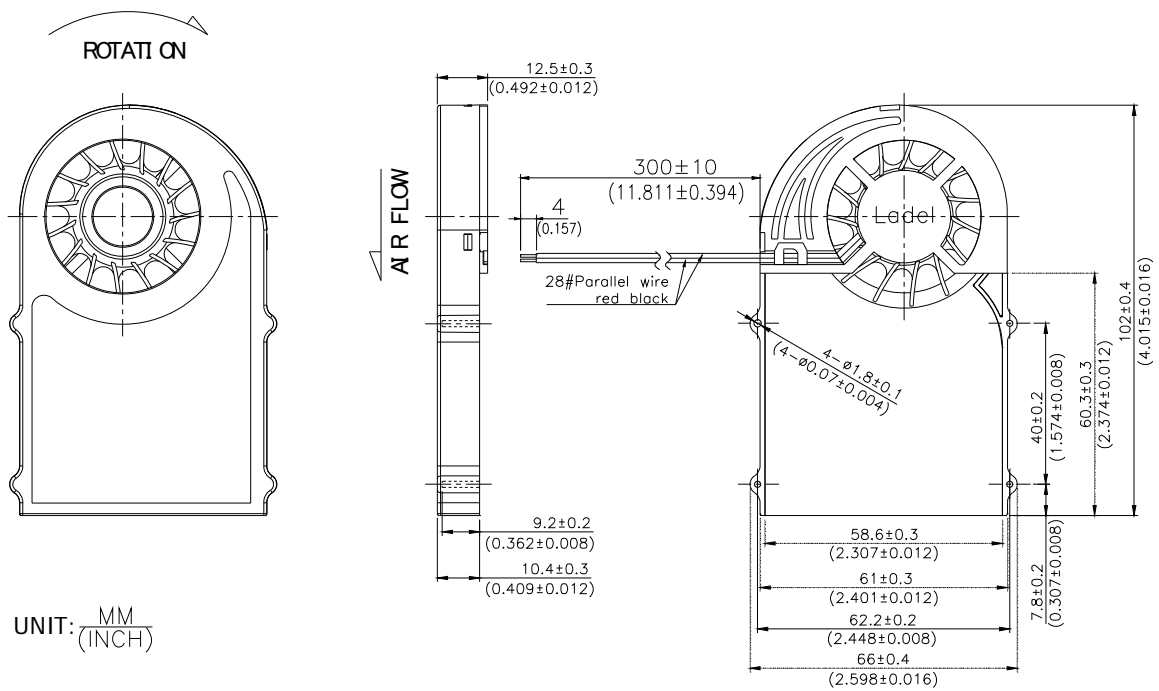

Figure 2. Fan Dimension & Assembly



Notes:

1. Tolerances:
2. Impeller must not protrude beyond front surface
3. Minimum 0.50 radius at all rib intersections
4. Unit: mm